

Meeting

Subject

-
-
-
-
-
-
-
-

Division

Recomn

Commu



SACRAMENTO CITY UNIFIED SCHOOL DISTRICT
COMMUNITY FACILITIES DISTRICT No. 2

SPECIAL TAX REPORT

FISCAL YEAR 2012-13
JULY 2012

PURSUANT TO THE MELLO-ROOS COMMUNITY FACILITIES ACT OF 1982

ENGINEER OF WORK:
SCIConsultingGroup
4745 MANGELS BOULEVARD
FAIRFIELD, CALIFORNIA 94534
PHONE 707.430.4300
FAX 707.430.4319
www.sci-cg.com

TABLE OF CONTENTS

TABLE OF CONTENTS 2

SUMMARY 3

ADMINISTRATION OF COMMUNITY FACILITIES DISTRICT 5

 GENERAL ADMINISTRATIVE REQUIREMENTS 5

 DELINQUENCY PROCEDURES 5

 NOTICES OF SPECIAL TAX LIEN 5

 REPORTING REQUIREMENTS 7

Public Information 7

Assessor and Auditor Filing and Reporting 7

CDIAC Reporting 7

RATE AND METHOD OF A

Table 2 summarizes the number of parcels taxed each year, the total tax per year, and the corresponding mitigation rates applied for the year of parcel development.

Table 2

Summary of Special Tax Levies by year

ADMINISTRATION OF COMMUNITY FACILITIES DISTRICT

GENERAL ADMINISTRATIVE REQUIREMENTS

The Mello-Roos Community Facilities District Act of 1982 (the Act) requires that a Special Tax Report be prepared annually to identify the Special Tax Rate for all parcels to be assessed in the upcoming fiscal year. The levy data must subsequently be filed with the County Auditor before August 22 for inclusion on property tax bills.

After submission of the Special Tax levies, the final levies should be confirmed with the County Auditor prior to the preparation of tax bills, which typically occurs in October. The Special Tax is collected in two equal installments on the tax bills that are due on December 10 and April 10.

DELINQUENCY PROCEDURES

The District participates in the "Teeter Plan" whereby the Counties pay all delinquent special taxes to the District and in return the Counties institute collection proceedings and, when collected, keep all delinquent payments with interest and penalties. This plan allows the District to maintain reliable special tax revenues and reduces the cost of collection.

The District reviews the Tax Collector's public records annually by June 30 to determine the amount of special tax revenues and delinquencies during the fiscal year. If the amount of collections is less than 95% of the amount of special tax levy in such fiscal year, the School District has covenanted with bondholders to institute foreclosure proceedings no later than October 31 to enforce the lien against delinquent installments. The District is also obligated to institute foreclosure proceedings in the case of a single property owner who is delinquent by more than \$2,000. No property owner is currently delinquent by such amount and the delinquency rate on the special taxes is below 5%, so there is no requirement to commence foreclosure proceedings at this time.

NOTICES OF SPECIAL TAX LIEN

The Act states "Tax levyrm Tw43 TD(om Tw43 TD(om Tw43 TD(om Tw43 TD(om Tw43 TD(om TA)T03 for06 seivv

SACRAM

annually determined by the Board at the time taxes are levied and to be used to calc

SACRAMENTO CITY UNIFIED SCHOOL DISTRICT
COMMUNITY FACILITIES DISTRICT No. 2

SPECIAL TAX RE 754 g(2)Tj0 g-.0419 .0419 TD(2)Tj.754 g.497 -.TD(U)Tj0 g-.0451 TD.7401 Tm.754 g54 g.594 -.0451 TD(X)Tj1 TD77.70T4(X)Tj.754 g.58.58.58.58U

5. Collection of Installments of the Special Tax

Installments of the Special Tax that are to be collected annually shall be collected upon the applicable Assessor's Parcels in the CFD in the same manner as ordinary ad valorem property taxes are collected and in accordance herewith; provided, however, that the CFD may collect installments at a different time or in a different manner if necessary to meet its financial obligations. All annual installments of Special Taxes shall be subject to the same penalties and lien priorities in the case of delinquency as is provided for ad valorem taxes. The Board shall cause the actions required above to be done for each Fiscal Year in a timely manner to assure that the Tax Collection Schedule is received by the Auditor of the County of Sacramento for inclusion with billings for ad valorem taxes for the applicable Fiscal Year.

6. Termination of the Special Tax.

The owner of a Parcel for which the Special Tax was not paid in full when due may, at any time thereafter, pay and permanently satisfy the Special Tax levied against such Parcel by paying to the Superintendent, by cashier's check or certified check payable to the CFD, an amount equal to the product of the Carryover Amount and the prepayment factor for the Fiscal Year in which such payment is made as shown in the table under paragraph 4(C) above.

In the event the Special Tax has been paid and permanently satisfied with respect to a Parcel, the Board shall record a Notice of Cancellation of Special Tax Lien as to that Parcel pursuant to Section 53344 of the Government Code. The Notice of Cancellation of Special Tax Lien shall identify with particularity the Special Tax that has been paid and permanently satisfied, shall contain the book and page number in the records of the county recorder where the Notice of Special Tax Lien being canceled is recorded, shall contain the legal description and assessor's parcel number of the particular Parcel of land subject to the lien, and shall contain the name of the owner of record of the Parcel. The Board may specify a charge payable by the owner of record for the preparation and recordation of this notice.

7. Appeals and Interpretation Procedure.

Any taxpayer subject to the Special Tax claiming that the amount or application of the Special Tax or an annual installment thereof has not been properly computed may file a notice with the Superintendent appealing the levy or collection of the Special Tax or annual installment. The Superintendent will promptly review the appeal and, if necessary, meet with the applicant and decide the appeal. If the findings of the Superintendent verify that the tax should be modified or changed, the Tax Collection Schedule shall be corrected if necessary and, if applicable, a refund shall be granted in accordance with Section 8 hereof. Any dispute over the decision of the Superintendent shall be referred to the Board, and the decision of the Board with respect to the Special Tax or annual installment shall be final.

Interpretation may be made by resolution of the Board for purposes of clarifying any vagueness or uncertainty as it relates to the application of the Special Tax rate, the calculation of the amount of any annual installment or prepayment amount, the application of the method of apportionment, the classification of Parcels, or any definition applicable to the CFD.

SACRAMENTO

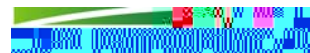
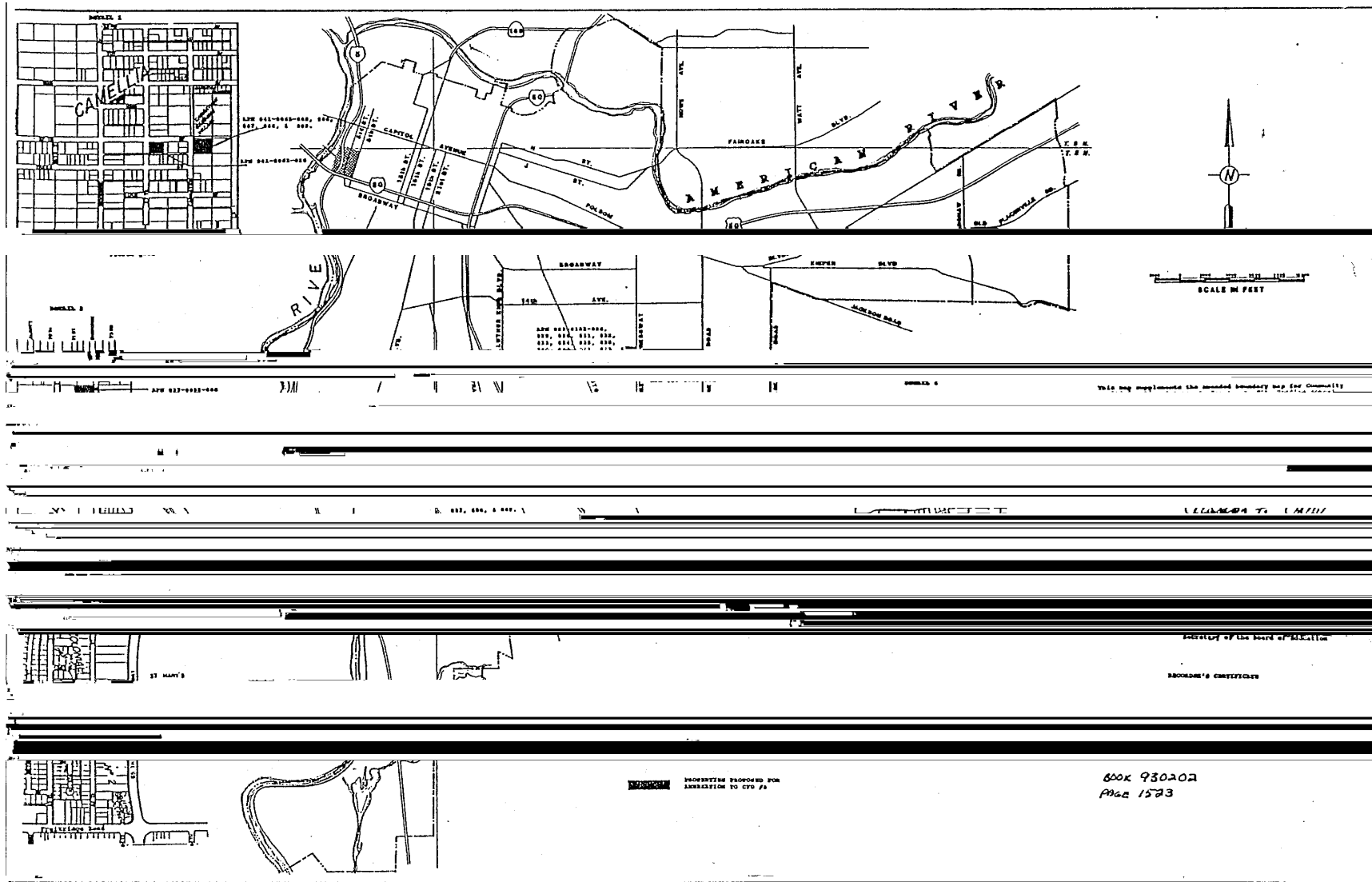

SECRETARY'S MAP FILING STATEMENT

MAP OF PROPOSED BOUNDARY
ANNEXATION NO. 4

COMMUNITY FACILITIES DISTRICT NO. 2
CITY OF SACRAMENTO, SACRAMENTO COUNTY,

City Consultants, Inc.

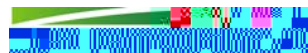

2012-13 SPECIAL TAX ROLL

The tax roll listing the fiscal year 2012-13 Special Tax for all Assessor's Parcels of land within the boundaries of the Community Facilities District No. 2 (CFD #2) of the Sacramento City Unified School District has been filed with the District and is included herein by reference. The tax attributed to each parcel was computed in accordance with the Rate and Method of Apportionment of Special Tax summarized beginning on Page 8.

Any parcels within CFD #2 for which building permits for residential construction were not issued as of June 30, 2012 are not taxed for the 2012-13 fiscal year. These parcels were not taxed for the 2012-13 fiscal year.

NOTICE OF SPECIAL TAX

COMMUNITY FACILITIES DISTRICT NO. 2
SACRAMENTO CITY UNIFIED SCHOOL DISTRICT
COUNTY OF SACRAMENTO, CALIFORNIA

TO: THE PROSPECTIVE PURCHASER OF THE REAL PROPERTY KNOWN AS:

Three horizontal lines for entering the purchaser's name.

This information is Valid Through June 30, 2013.

THIS IS A NOTIFICATION TO YOU PRIOR TO YOUR PURCHASING THIS PROPERTY. THE SELLER IS REQUIRED TO GIVE YOU THIS NOTICE AND TO OBTAIN A COPY SIGNED BY YOU TO INDICATE THAT YOU HAVE RECEIVED AND READ THIS NOTICE.

- (1) This property is subject to a special tax, which is in addition to the regular property taxes and any other charges and benefit assessments on the parcel. This special tax may not be imposed on all parcels within the city or county where the property is located. If you fail to pay this tax when due each year, the property may be foreclosed upon and sold. The tax is used to provide public facilities or services that are likely to particularly benefit the property. YOU SHOULD TAKE THIS TAX AND THE BENEFITS FROM THE PUBLIC FACILITIES AND SERVICES FOR WHICH IT PAYS INTO ACCOUNT IN DECIDING WHETHER TO BUY THIS PROPERTY.
(2) The maximum annual special tax which may be levied against this parcel to pay for public facilities is \$_____ during the 2012-13 tax year, payable at time of issuance of building permit. In the event that a building permit for residential construction on the property for an increase in the residential assessable space in excess of 500 square feet is issued, the maximum annual special tax will be increased by an amount equal to the net increase in residential area times the residential special tax rate in effect in the tax year that such building permit is issued. In addition, an annual special tax will be charged in fiscal year 2013-14 for building permits issued between July 1, 2012 and June 30, 2013 as follows: \$0.7686 per square foot of new single family residential area and \$0.448 per square foot of new multi-family residential area. The annual special tax will be levied for 30 years and the annual tax levy will increase according to the tax collection schedule by an annual amount not to exceed approximately 13%.
(3) The authorized facilities which are being paid for by the special taxes, and by the money received from the sale of bonds which are being repaid by the special taxes, to the extent that financing is available, are:
1) The repair, rehabilitation, modification and expansion of existing elementary and secondary school facilities;
2) The acquisition of sites and the construction of elementary and secondary school facilities with related appurtenances and support structures;
3) The acquisition of sites and the construction of non-school facilities to support District operations; and
4) The acquisition of related equipment and furnishings; all necessary to meet student population demands.

These facilities may not yet have all been constructed or acquired and it is possible that some may never be constructed or acquired.

In addition, the special taxes may be used to pay for costs of the following services: None

YOU MAY OBTAIN A COPY OF THE RESOLUTION WHICH AUTHORIZED CREATION OF THE COMMUNITY FACILITIES DISTRICT WHICH SPECIFIED MORE PRECISELY HOW THE SPECIAL TAX IS APPORTIONED AND HOW THE PROCEEDS OF THE TAX WILL BE USED, FROM THE SACRAMENTO CITY UNIFIED SCHOOL DISTRICT BY CALLING 264-4080. THERE MAY BE A CHARGE FOR THIS DOCUMENT NOT TO EXCEED THE ESTIMATED REASONABLE COST OF PROVIDING THE DOCUMENT.

I (WE) ACKNOWLEDGE THAT I (WE) HAVE READ THIS NOTICE AND RECEIVED A COPY OF THIS NOTICE PRIOR TO ENTERING INTO A CONTRACT TO PURCHASE OR DEPOSIT RECEIPT WITH RESPECT TO THE ABOVE REFERENCED PROPERTY. I (WE) UNDERSTAND THAT I (WE) MAY TERMINATE THE CONTRACT TO PURCHASE OR DEPOSIT RECEIPT WITHIN THREE DAYS AFTER RECEIVING THIS NOTICE IN PERSON OR WITHIN FIVE DAYS AFTER IT WAS DEPOSITED IN THE MAIL BY GIVING WRITTEN NOTICE OF THAT TERMINATION TO THE OWNER, SUBDIVIDER, OR AGENT SELLING THE PROPERTY.

DATE _____

**SACRAMENTO CITY UNIFIED SCHOOL DISTRICT
BOARD OF EDUCATION**

RESOLUTION NO. 2719

**A RESOLUTION APPROVING THE SACRAMENTO CITY
UNIFIED SCHOOL DISTRICT COMMUNITY FACILITIES
DISTRICT NO. 2 TAX REPORT FOR FISCAL YEAR 2012-13
AND LEVYING AND APPORTIONING THE SPECIAL TAX
AS PROVIDED THEREIN**

**SACRAMENTO CITY UNIFIED SCHOOL DISTRICT
COMMUNITY FACILITIES DISTRICT NO. 2**

WHEREAS, the Governing Board of the Sacramento City Unified School District (the "Board") on January 27, 1992 duly adopted Resolution No. 1588 (the "Resolution") establishing Sacramento City Unified School District Community Facilities District No. 2 (the "Community Facilities District," or "CFD No. 2") for the purpose of providing for the financing of certain facilities in and for CFD No. 2 and providing for the levy of a special tax in and for CFD No. 2.

WHEREAS, the Sacramento City Unified School District Community Facilities District No. 2 Tax Report, Fiscal Year 2012-13 (the "Tax Report") has been submitted to the Board and the Board has determined to approve the Tax Report to levy the special tax at the rates specified in the Tax Report and to apportion them in the manner specified therein.

NOW, THEREFORE, the Board, acting on behalf of CFD No. 2, resolves as follows:

Section 1. The Sacramento City Unified School District CFD No. 2 Tax Report, Fiscal Year 2012-13, in the form submitted to this meeting and on file with the Board is hereby approved and adopted.

Section 2. Pursuant to section 53340 of the Government Code of the State of California, the special tax is hereby levied at the rates specified in the Tax Report and is hereby apportioned in the manner specified in the Resolution (and as more particularly described in the Tax Report).

Section 3. Pursuant to section 53340 of the Government Code of the State of California, the special tax shall be collected by the Tax Collector of the County of Sacramento in the same manner as ordinary ad valorem property taxes are collected and shall be subject to the same procedure, sale, and lien priorities in case of delinquency as is provided for ad valorem taxes, subject to all other conditions set forth in the Resolution.

Section 4. In order to have the tax levied hereby collected in the next tax collection period and thus available to finance the facilities approved by the electors of CFD No. 2, the Superintendent shall deliver the Tax Report together with a certified copy of this Resolution to the tax collector of the County of Sacramento no later than August 22, 2012.

Section 5. The Superintendent and his designees are hereby authorized to make changes to the Tax Report in response to appeals from taxpayers or otherwise in order to correct errors that may, from time to time, arise in the application of the special tax to particular parcels. Claims for refund of the tax shall comply with the following and any additional procedures as established by the Board:

(a) All claims shall be filed with the Superintendent of the Sacramento City Unified School District no later than one year after the date the tax was paid. The claimant shall file the claim within this time period and the claim shall be finally acted upon by the Board as a prerequisite to bringing suit thereon.

(b) Pursuant to Government Code section 935(b), the claim shall be subject to the provisions of Government Code sections 945.6 and 946.

(c) The Board shall act on a timely claim within the time period required by Government Code section 912.4.

(d) The procedure described in this Resolution, and any additional procedures established by the Board, shall be the exclusive claims procedure for claimants seeking a refund of the tax. The decision of the Board shall be final.

APPROVED, PASSED, AND ADOPTED by the Governing Board of the Sacramento City Unified School District this 16th day of August 2012, by the following vote, to wit:

AYES:

NOES:

ABSTAIN:

ABSENT:

President of the Board of Education

ATTEST:

Secretary of the Board of Education